



21 Sheppard Drive, London, SE16 3EJ

A generous, two bedroom apartment located a walk away from Bermondsey Underground Station.

The apartment boasts a spacious reception room with space to dine, a well-kept kitchen with plenty of storage, spacious double bedroom with built-in storage, a second bedroom currently being used as an office, and a neat family bathroom. Additional storage can be found in the hallway.

The property is surrounded by many local amenities such as local cafes, restaurants, gym, Southwark Park, local markets, and great transport links into central London.

- Spacious Two Bedroom Apartment
- Part Furnished
- Plenty of Storage
- Good Transport Links
- Surrounded by Local Amenities

Alex & Matteo
ESTATE AGENTS

£1,700 Per month



Sheppard Drive SE16

Approximate Area = 548 sq ft / 50.8 sq m

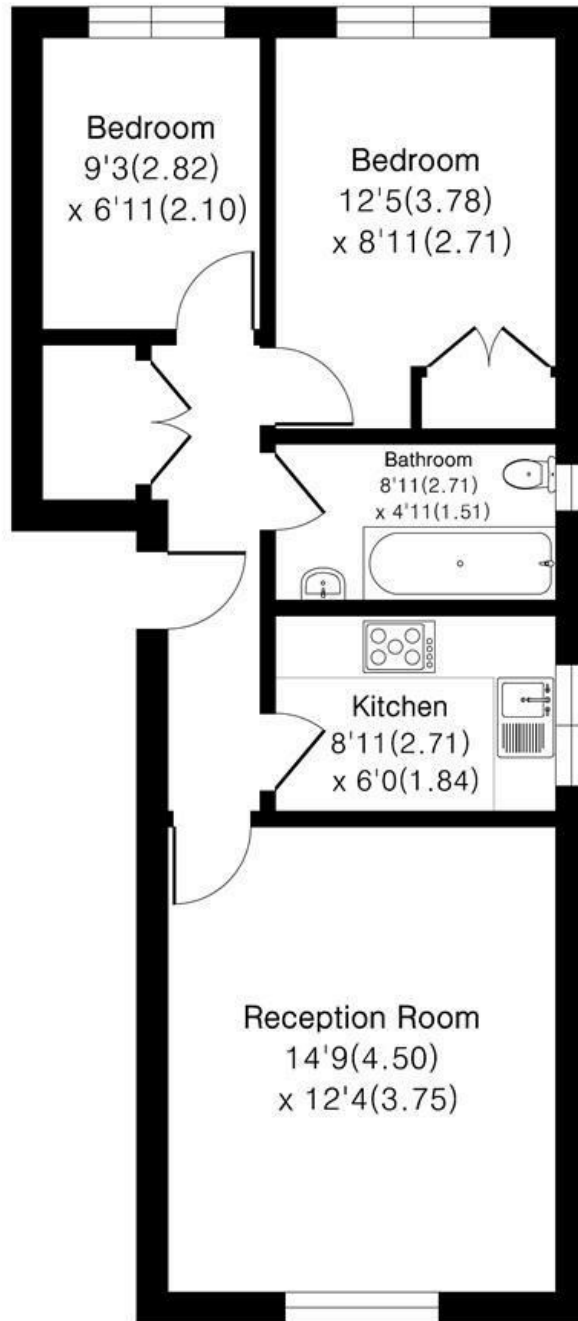

First Floor



Floor plan Produced in accordance with RICS Property Measurement 2nd Edition.
Incorporating International Property Measurement Standards (IPMS2 Residential).
Produced for Alex & Matteo Estate Agents.

Energy Efficiency Rating		
	Current	Potential
Very energy efficient - lower running costs		
(92 plus) A		
(81-91) B		
(69-80) C		
(55-68) D		
(39-54) E		
(21-38) F		
(1-20) G		
Not energy efficient - higher running costs		
	73	81
England & Wales		
EU Directive 2002/91/EC		